

Cleaning the **nexus**TM ON A GRAVITY FED SYSTEM

Follow these cleaning instructions if the Nexus is installed on a gravity-fed setup when a **bottom drain** in the pond **delivers** water into your Nexus.

EVOLUTION
AQUA
INNOVATION IN WATER



Switch the circulation pump **off**.
Wait for 1 minute.

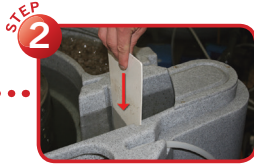

Insert the inlet slide plate.



Insert the cleaning pipe into the centre of the Eazy.



Open air valve to the inner chamber.



Close the air valve to the outer chamber.



Allow the K1 Micro in the Eazy to **agitate** for **5 minutes**.



Open the larger waste valve and wait for the inner chamber to empty.



At this stage you may want to **hose down** any debris from underneath the Eazy.



Close the waste valve.



Open the air valve to the outer chamber.



Close the air valve to the inner chamber.



Remove the inlet slide plate and wait until the inner chamber has filled with water.



Once inner chamber has filled, **remove** the cleaning pipe.



Switch the circulation pump **on**.

Steps 2 to 13 should be repeated until the Eazy is clean.

GRAVITY FED CLEANING INSTRUCTIONS – NEXUS 220 & 320